



CHECKED: ANT/JGM
DRAWN: JGM

REVISION DATE: APRIL 10, 2019

ISSUE DATE: MAY 2020

ARCHITECT REFERENCE NO. 94-1530-18

NO PART OF THIS DOCUMENT MAY BE USED OR COPIED IN WHOLE OR IN PART WITHOUT THE PRIOR WRITTEN CONSENT OF T.F., INC.

PROJECT NO: 20-217

T.F., Inc.
830 N. RIVERSIDE DRIVE
RINTON, MA 01807
PHONE: 425-970-3758
FAX: 425-970-3756

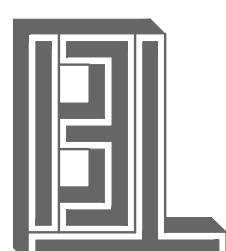

FUEL FACILITY
WAREHOUSE #141
330 VINTAGE WAY
NOVATO, CA 94945

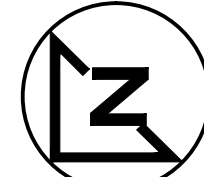

SE-1

LIGHTING FIXTURE SCHEDULE					
TYPE	MANUFACTURER	NUMBER	DESCRIPTION	WATT	REMARKS
Ⓞ	ORE	CP7250-B-PD-F-B-UL-WH-5000K	LED SURFACE MOUNT	96	
Ⓢ	EXISTING	35' POLE	EXISTING 35' POLE ON 2'-5" BASE	445	
Ⓢ	EXISTING	40' MH	EXISTING 40' MH		
Ⓢ	EXISTING	POLE	EXISTING POLE		
Ⓢ	EXISTING	FIXTURE	EXISTING FIXTURE		
Ⓢ	EXISTING	DISTRIBUTION	EXISTING DISTRIBUTION		
Ⓢ	EXISTING	TYPE & DISTRIBUTION	EXISTING TYPE & DISTRIBUTION		
Ⓢ	EXISTING	(ESTIMATE)	(ESTIMATE)		

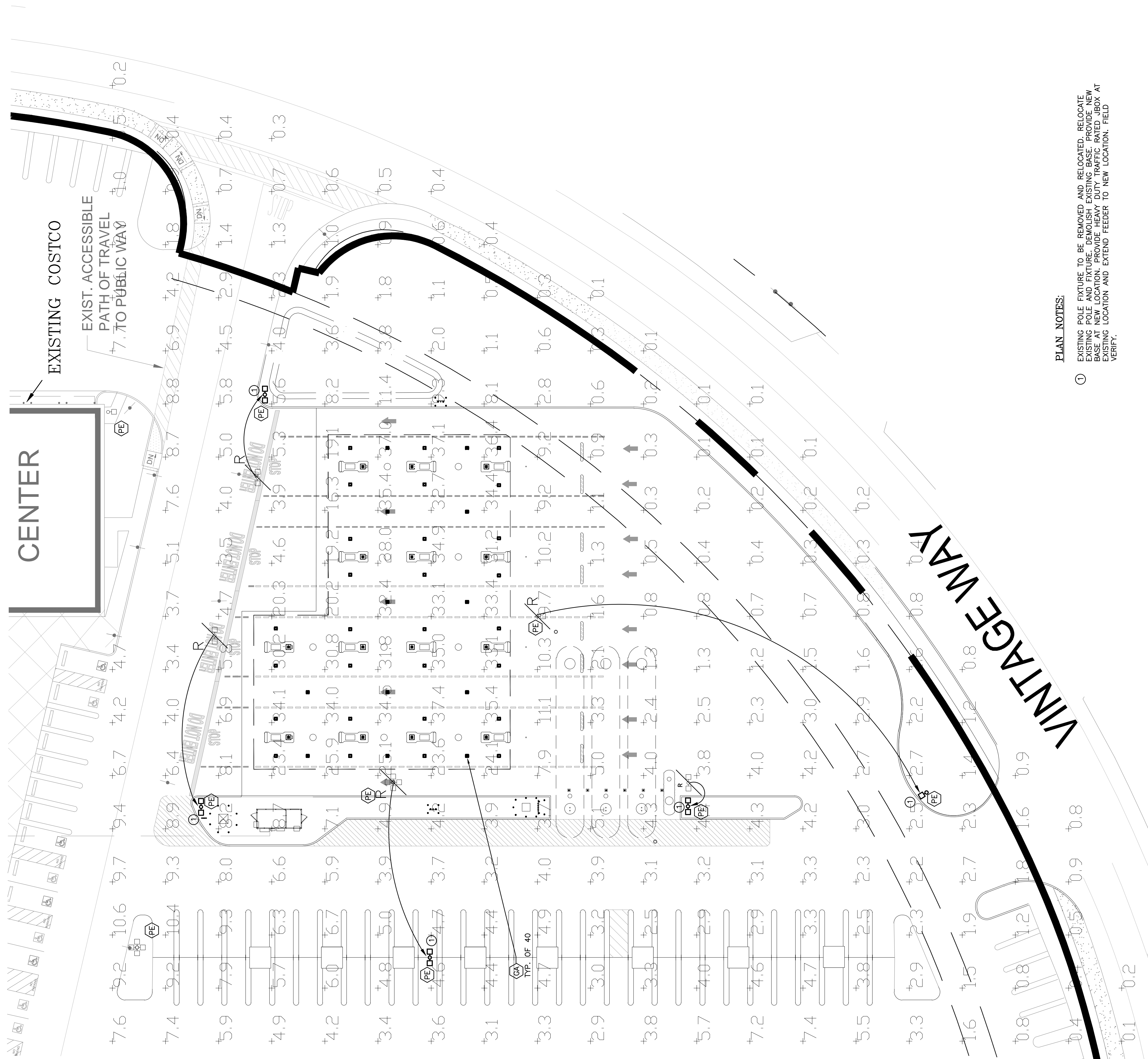

PLAN NOTES:
 ① EXISTING POLE FIXTURE TO BE REMOVED AND RELOCATED. RELOCATE EXISTING POLE AND FIXTURE. DEMOLISH EXISTING BASE. PROVIDE NEW BASE AT NEW LOCATION. PROVIDE HEAVY DUTY TRAFFIC RATED J-BOX AT LOCATION AND EXTEND FEEDER TO NEW LOCATION. FIELD VERIFY.

SITE PHOTOMETRIC PLAN
SCALE: 1" = 20'-0"

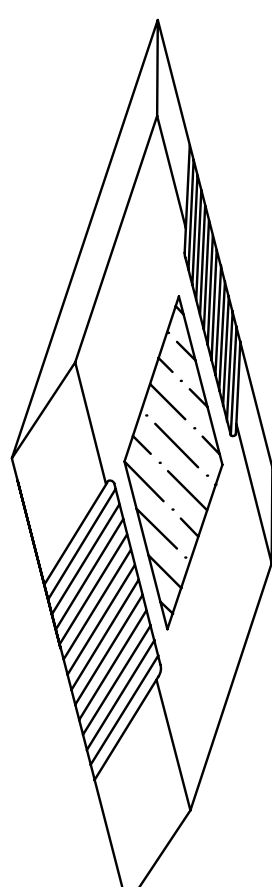

FUEL FACILITY - LED (GA)
NO SCALE

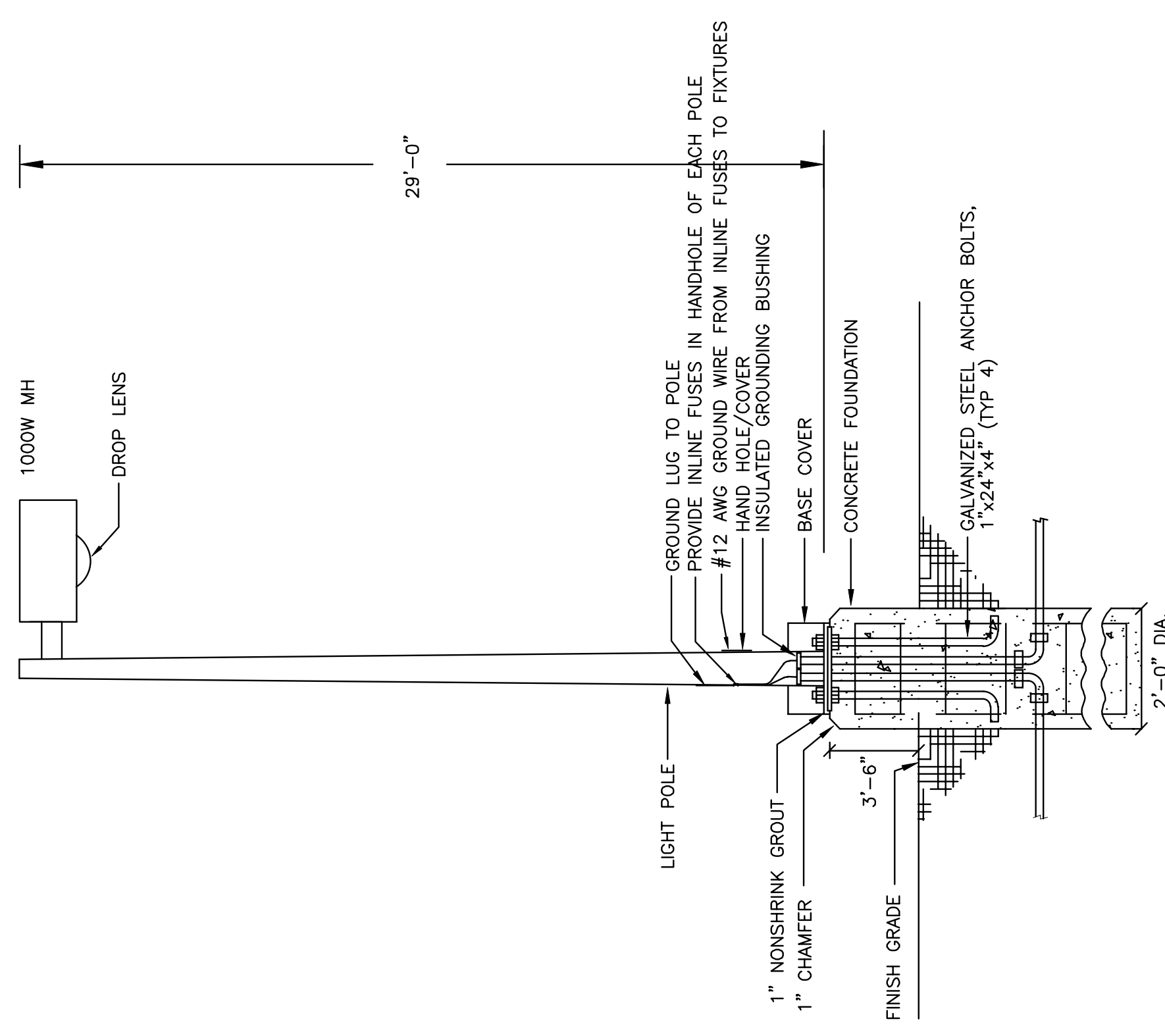

NOTE: PROVIDE CONCRETE J-BOX AS REQUIRED. THIS DETAIL IS FOR ELECTRICAL CONDUITS ROUTING ONLY. SEE STRUCTURAL DRAWINGS FOR CONSTRUCTION DETAIL.

POLE BASE DETAIL
NO SCALE