

Guide to Kitchen Remodels, Receptacles and Small Appliance Circuits

General

- 1) At least two 20-ampere branch circuits shall supply kitchen countertop receptacles.
- 2) Wall Counter Spaces (See Figure 1):
 - a) A receptacle shall be installed for any counter that is 12 inches wide or greater; and,
 - b) No point on the kitchen counter, measured at the wall may be more that 24 inches away from a receptacle. Also known as the 2ft. / 4ft. rule (See Figure 2 for explanation).
- 3) Island and Peninsular Counter Spaces (See Figure 1):
 - a) At least one receptacle is required for an island or peninsular counter with dimensions of at least 24 inches by 12 inches;
 - b) At least one receptacle outlet shall be provided for the first 9 square feet; an additional outlet shall be provided for every additional 18 square feet or fraction thereof.
 - c) An island counter with a rangetop or sink installed where the dimension behind the rangetop or sink to the edge of the counter is less than 12 inches is considered as two separate island countertops; and,
 - d) A peninsular countertop is measured from the connecting edge.

Fig. 1

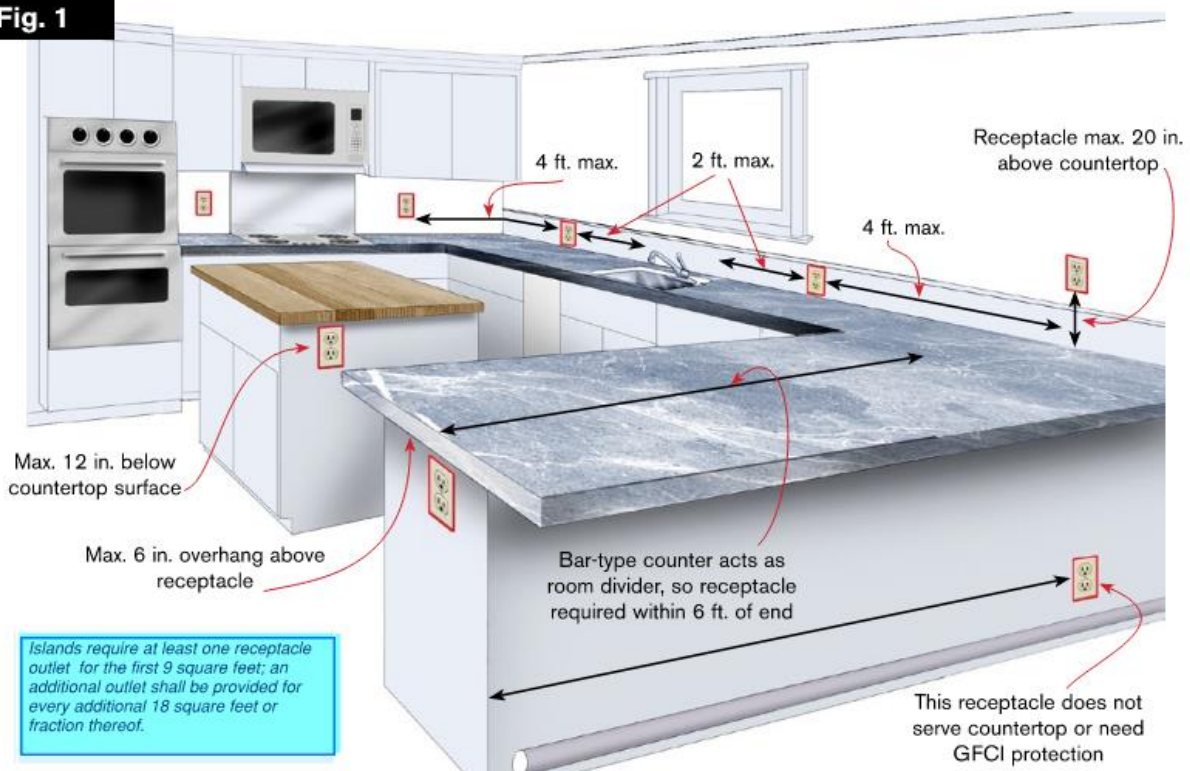
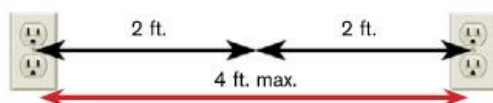

Fig. 2



Wall countertop receptacles serve spaces for 2ft. on each side of the receptacle. Therefore, the max. spacing between receptacles on the same countertop spaces is 4 ft.

- 4) Receptacle installation (See Figure 1):
 - a) Maximum of 20 inches above countertop;
 - b) Maximum of 12 below island or peninsular countertops;
 - c) Island or peninsular countertops may not extend more than 6 inches beyond the cabinet housing the receptacle; and,
 - d) Receptacle may not be installed face-up in the countertop.
- 5) Ground-Fault Circuit-Interrupter (GFCI) protection is required for all receptacles serving kitchen countertops, as well as pantries, breakfast rooms, dining rooms and similar areas.
- 6) Countertops separated by sinks, ranges, or refrigerators shall be treated as separate spaces. The wall behind the sink or cook top is not to be treated as wall space unless the distance exceeds 12 inches to the wall or 18 inches to a corner (See Figures 3 and 4).

Fig. 3 Extended Range or Sink

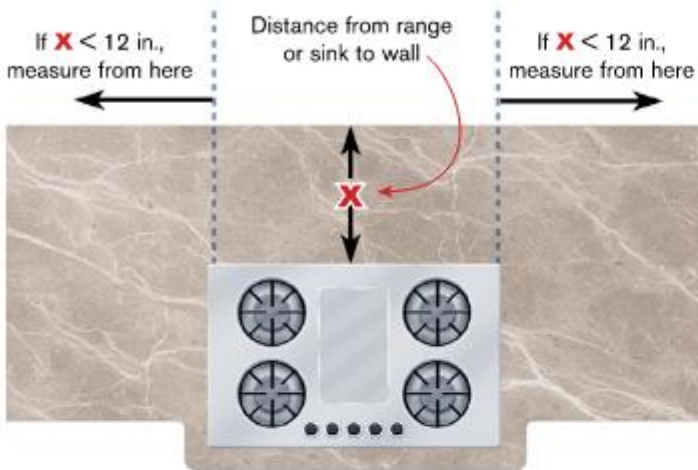

If $X \geq 12$ in., countertops are not considered separate spaces & the 2 ft./4 ft. rule applies to the entire countertop

Fig. 4 Corner Range or Sink

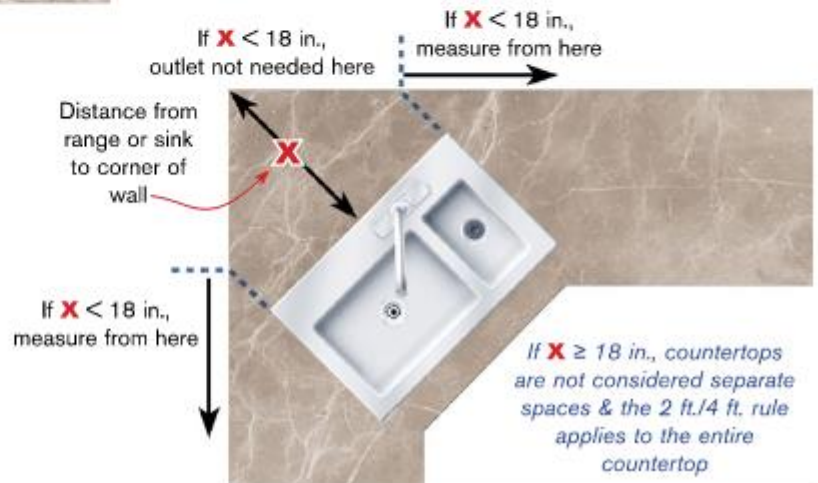

If $X \geq 18$ in., countertops are not considered separate spaces & the 2 ft./4 ft. rule applies to the entire countertop